



ALSANIT®

ALSANIT – WE CREATE SPACES

ALSANIT is a recognized brand, valued primarily for its exceptional durability and innovative design. Our mission is to deliver the highest quality products intended for investment outfitting.

European brand

With passion and commitment,
we are building the international
position of the **ALSANIT** brand.

20+

20 YEARS OF EXPERIENCE

25+

SALES TO OVER 25 COUNTRIES

2600+

2600 PROJECTS ANNUALLY

8000+

SQM OF ALSANIT'S HALL SPACE



Comprehensive offer

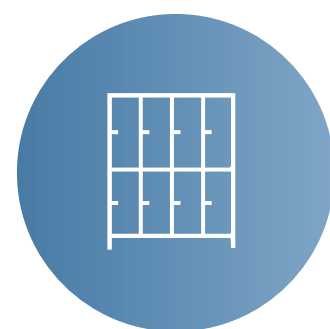

LOCKERS AND BENCHES

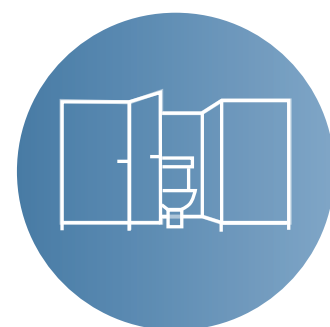

CUBICLES

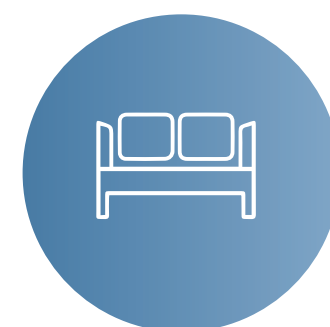

CONTRACT FURNITURE



SMART LOCKERS



We are proud to work with:



Mercury Tower, Malta
Zaha Hadid Architects



VARSO Tower, Warsaw
Foster and Partners



Hotel Hilton, Rome
THDP

Zurich Airport

Zurich Airport
Grimshaw



Dublin Airport
Desmond FitzGerald



Gigafactory, Berlin



SKANSKA



KFC



castorama



NH HOTELS



PANATTONI







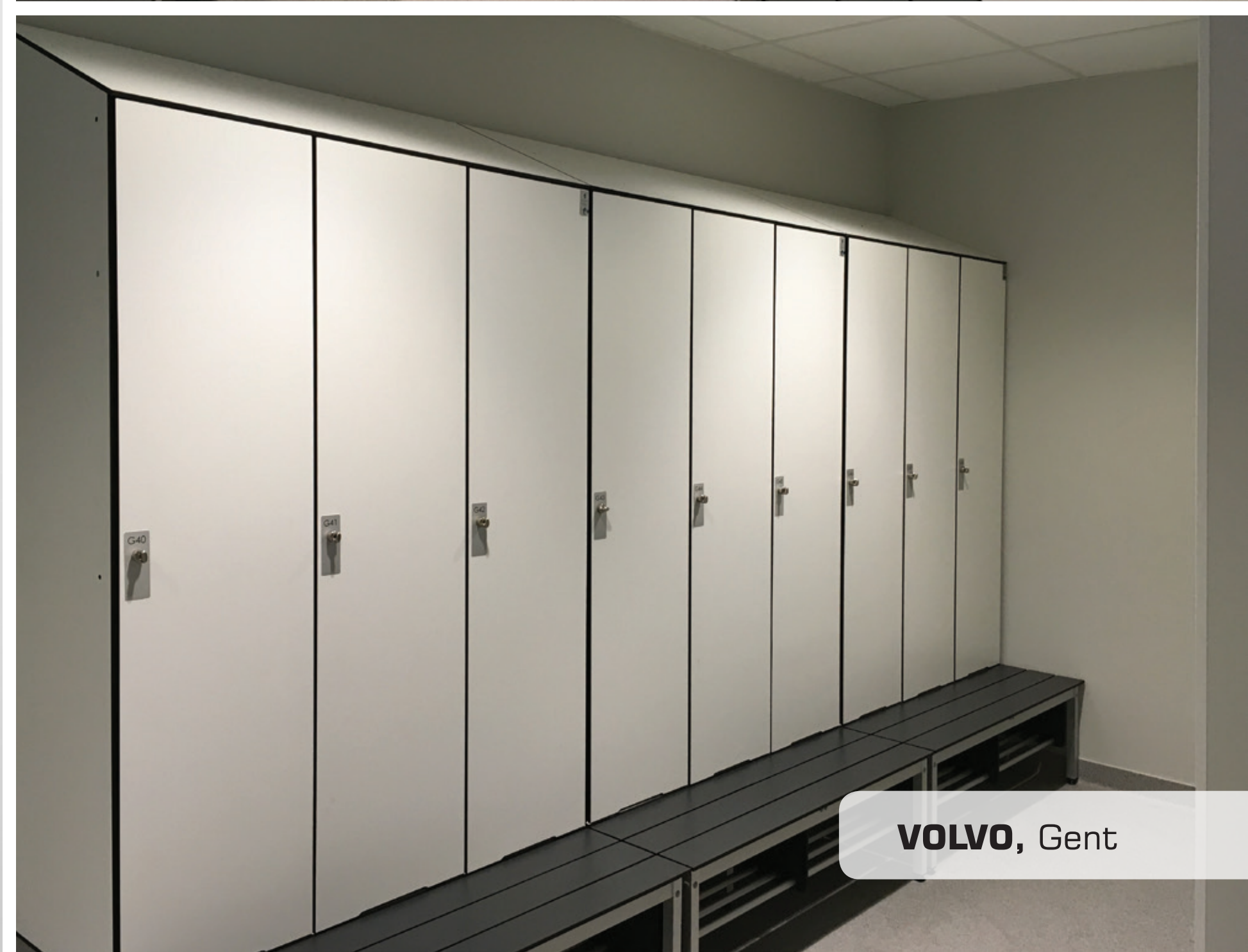







HET NIEUWE LYCEUM, Bilthoven



The only company with its own departments of:



METAL SHEET PROCESSING - AUTOMATED PRODUCTION AND AUTOMATED PAINTING LINE



BOARD PROCESSING - WITH AUTOMATED BOARD STOCK



ACCESSORY PRODUCTION

Widest material options.



20 years of innovation

What we do, we do better than others.



PATENTED MODULAR LOCKERS



IN-HOUSE HINGE WITH PATENTED GEOMETRY – EVEN GAPS BETWEEN DOORS REGARDLESS OF THE SYSTEM



IN-HOUSE WORKFLOW SYSTEM – REAL LIFE STATUS OF ORDER



The best prices

We offer exceptional quality and flexible solutions.



NUMEROUS MATERIAL AND CONFIGURATION OPTIONS ALLOW YOU TO TAILOR THE PRODUCT TO YOUR BUDGET



TOP QUALITY AT A SURPRISINGLY GOOD PRICE



WE OPTIMIZE SOLUTIONS





Above all - QUALITY

Products



ALWAYS
GALVANIZED STEEL



REINFORCED
DOOR/BODY COMPONENTS
AS STANDARD



EXCELLENT VENTILATION

Organization

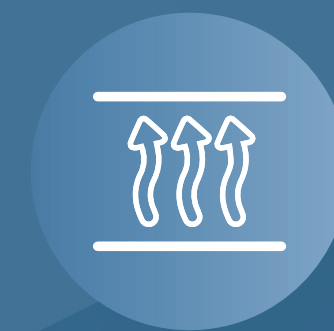

MFC BOARDS LAMINATED
WITH **HOT-AIR**
TECHNOLOGY



PRODUCTION
AUTOMATION



TÜV + CE
INTERNATIONAL
CERTIFICATIONS



Lockers offer - configuration in 4 steps.

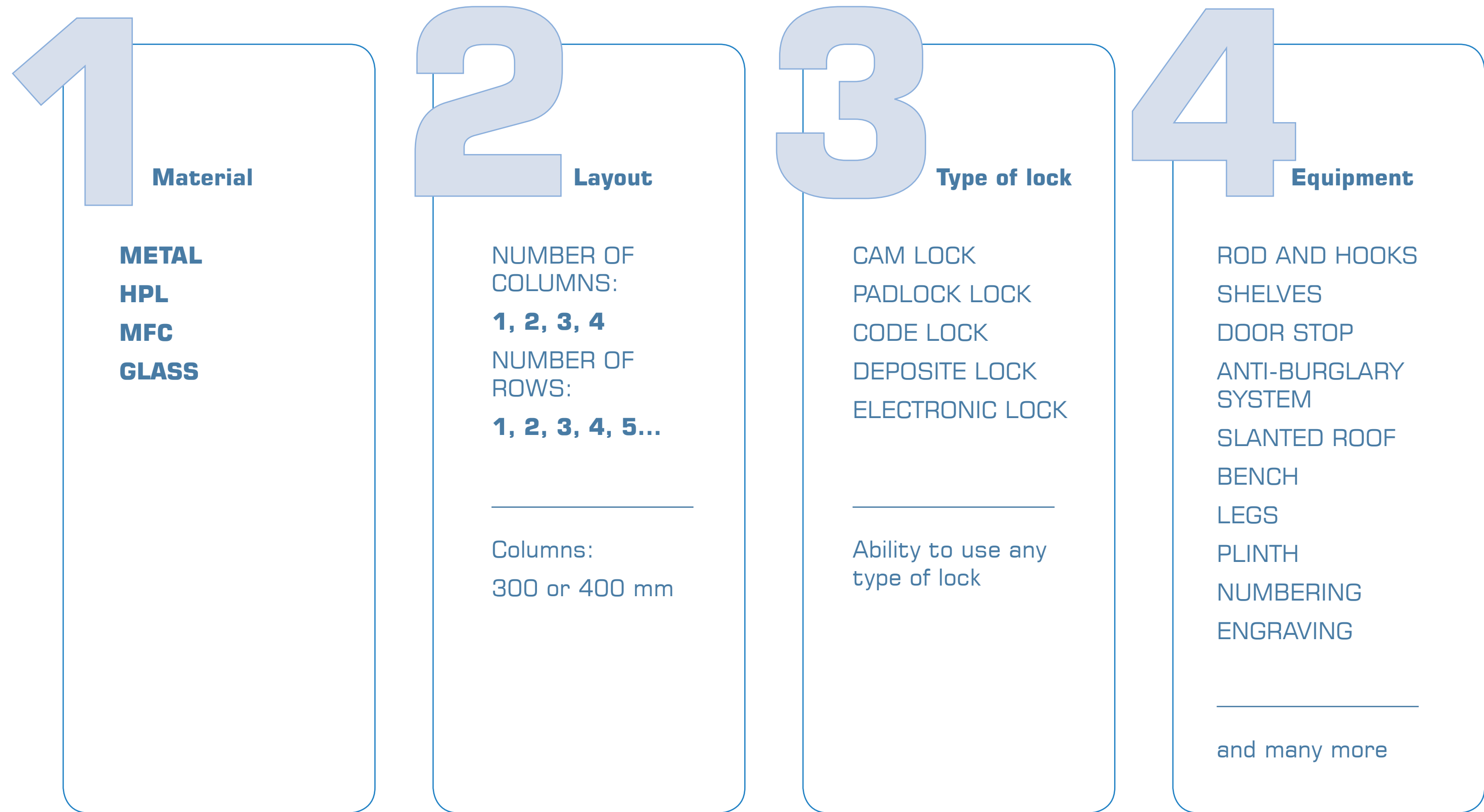

Metal lockers

COMBO

Ability to modify and reconfigure at any time.
Doors always in front of the body.

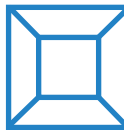

BODY:
METAL - Powder-coated galvanized steel (0.7 mm)



DOORS:
HPL - High pressure laminate
MFC - Laminated chipboard
GLASS - Tempered glass

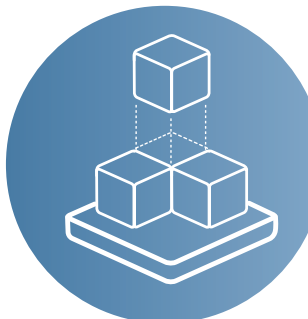

PATENTED
MODULAR LOCKERS



VELA

Basic model with reinforced doors.
Doors recessed into the body.



BODY:
METAL - Powder-coated galvanized steel (0.7 mm)



DOORS:
METAL - Powder-coated galvanized steel
HPL - High pressure laminate
MFC - Laminated chipboard

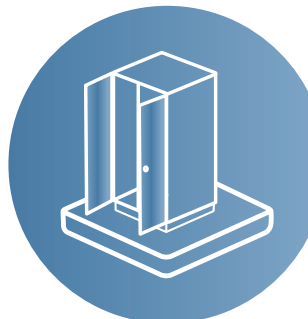

CENTRAL
ACCESS

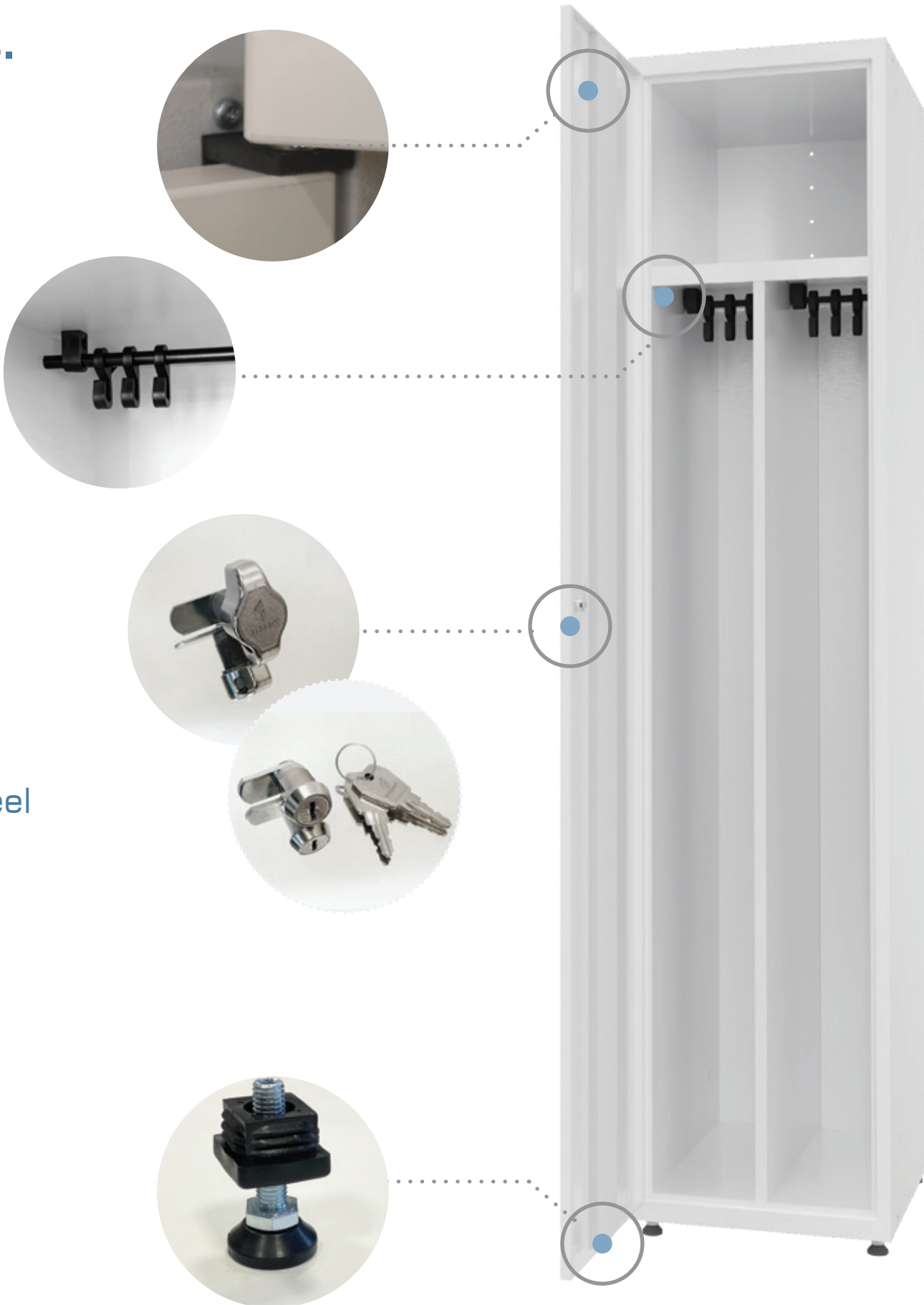

HPL lockers

TAURUS

Easy to keep clean due to flat body walls.



BODY:
HPL - High pressure laminate
(10 mm / back 4 mm)



DOORS:
HPL - High pressure laminate
(10 mm)



100%
WATERPROOF



ARTUS

Safe hinge, possibility to build Piano Locker.

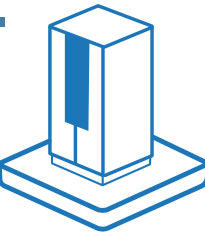

BODY:
HPL - High pressure laminate
(4 mm / 10 mm)

ALUMINUM - Anodized
aluminum profiles



DOORS:
HPL - High pressure laminate
(10 mm)

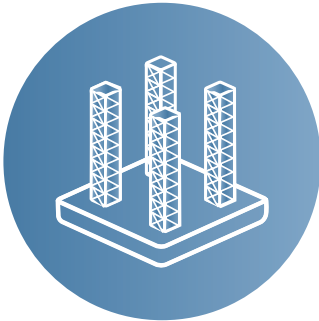

PATENTED
PROFILE SYSTEM



MFC lockers

Configure with:

LUXA

Great impression at a low cost.
Perfect for office lockers.

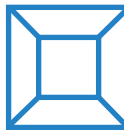

BODY:
MFC - Laminated chipboard
(18 mm)



DOORS:
MFC - Laminated chipboard
(18 mm)

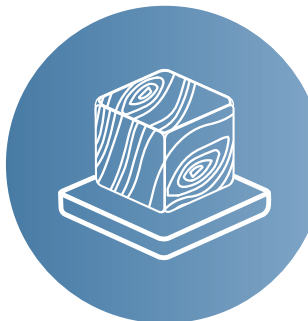

AVAILABLE IN HIGH
GLOSS AND 3D
DECORS



BENCHES

PRO-FI



LO-FI



HI-FI



Cubicles

PERSEI

Beauty, prestige, precision.
Fittings designed by **ALSANIT** engineers.

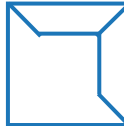

AVAILABLE IN:

MFC - Laminated chipboard (18/28 mm)

HPL - High pressure laminate (10/12 mm)

SP - Sandwich panels (36 mm)

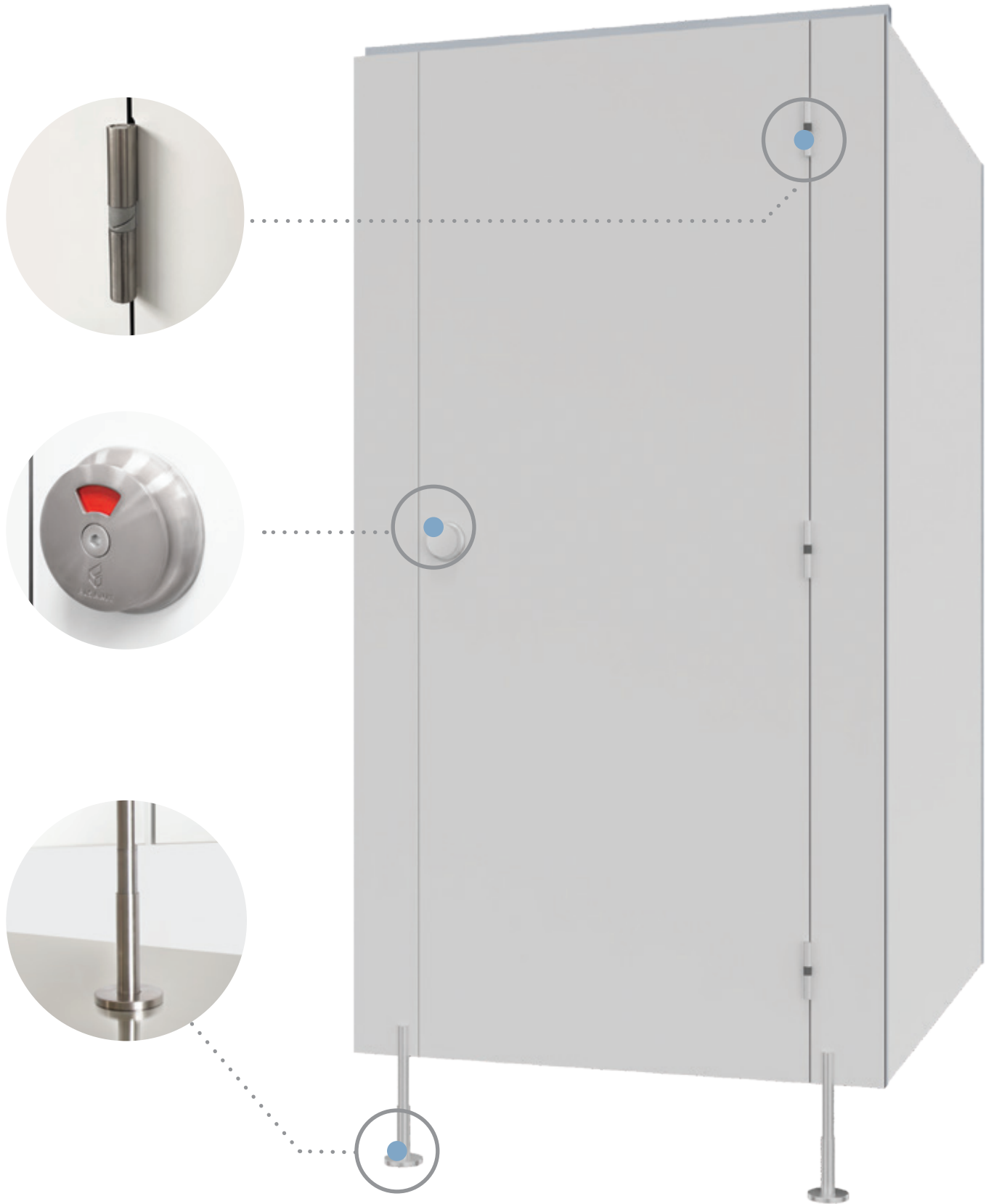

FITTINGS WITH
A BRUSHED STEEL
FINISH

AQUARI

Safety and aesthetics.
Ideal for educational facilities.



AVAILABLE IN:

MFC - Laminated chipboard (18 mm)

HPL - High pressure laminate (10/12 mm)

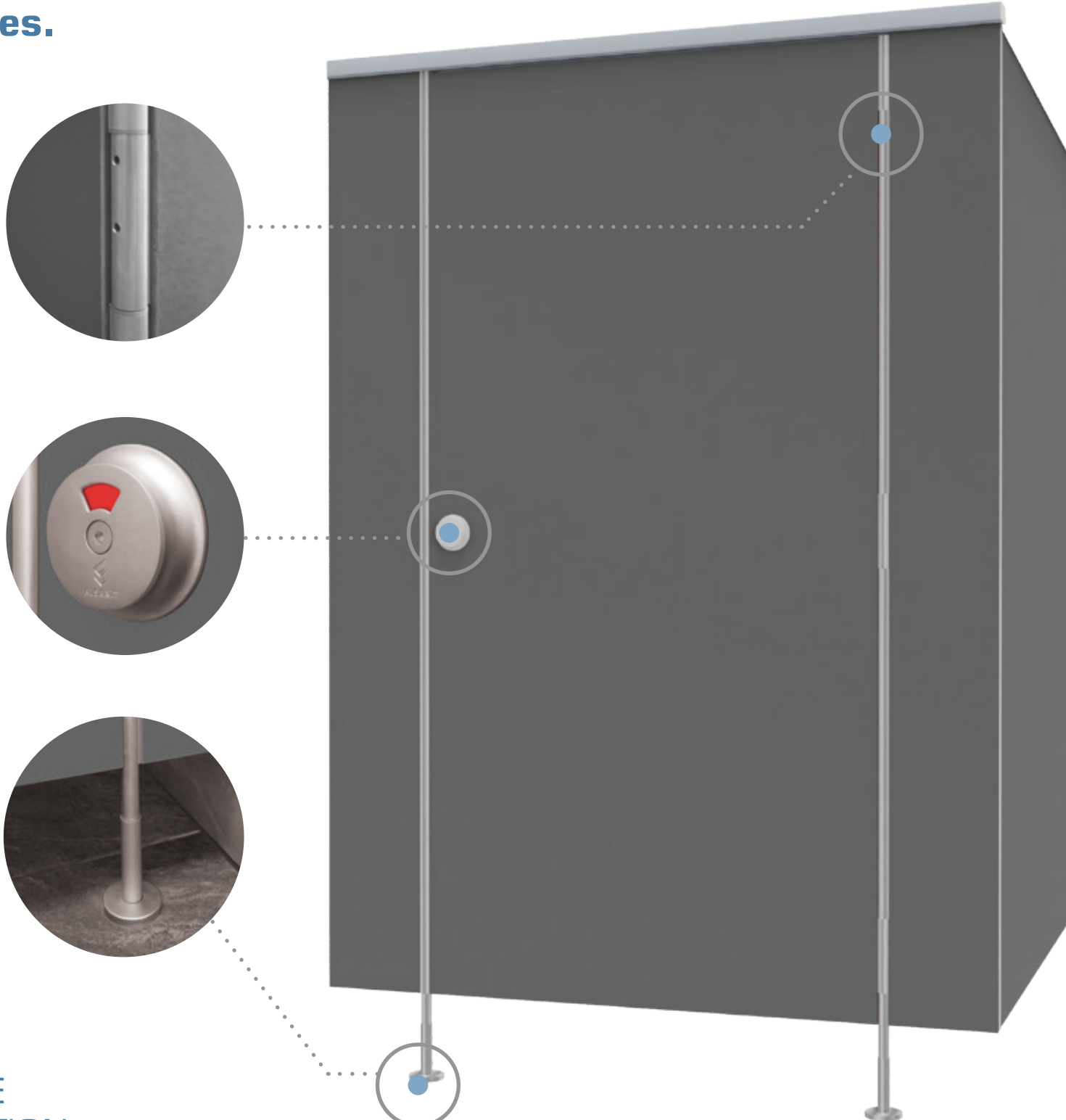

PATENTED SAFE
FINGERS SOLUTION

Contract furnitures

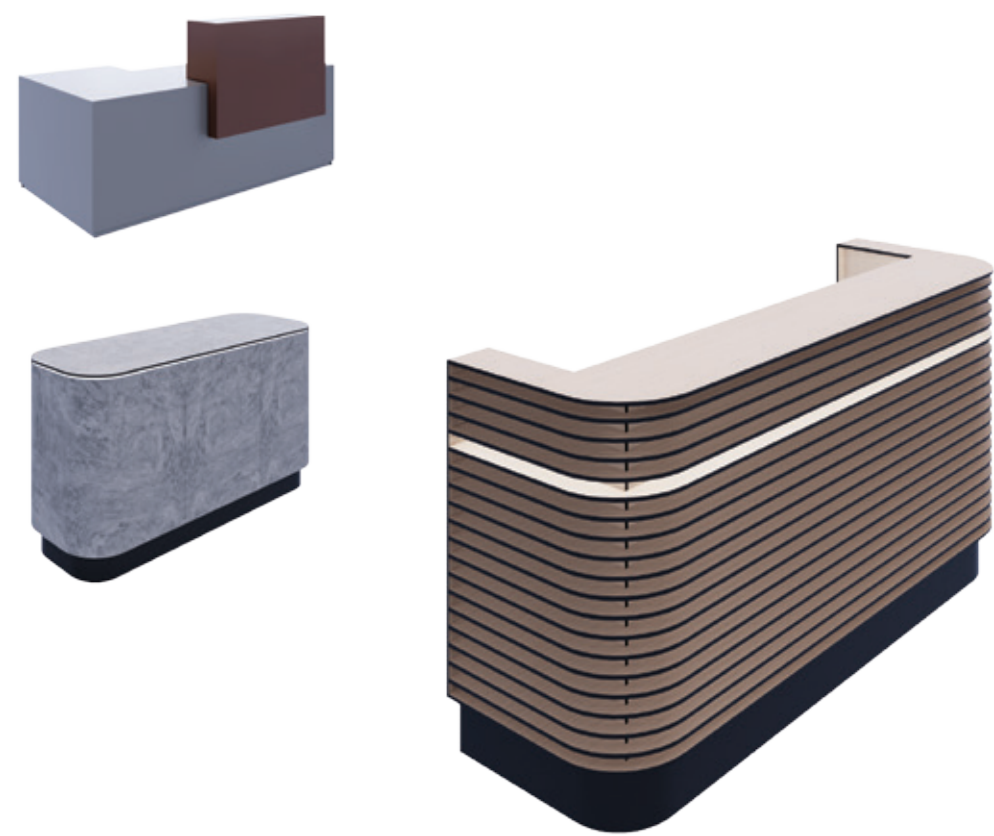

RECEPTIONS



TABLES



SHELVING



PARTITIONS



VANITY



GRIDO - MODULAR SHELVING



CHAIRS AND SOFAS

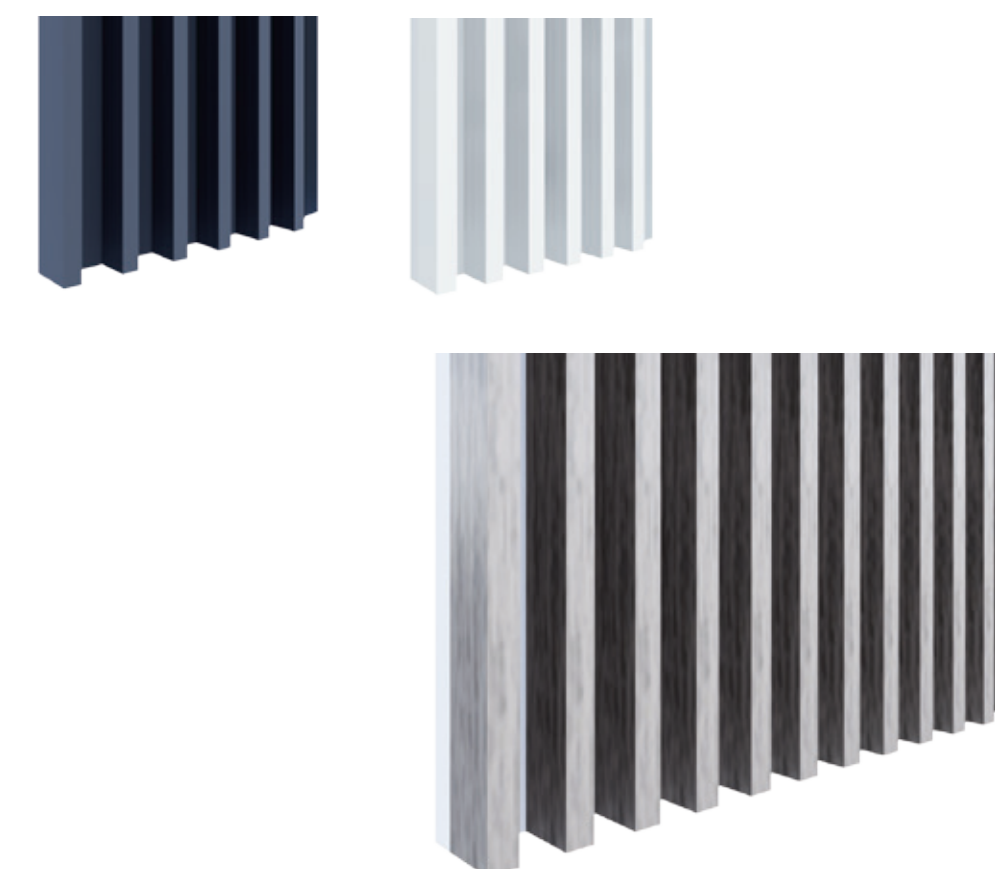

SLATS

ALSANIT



Alsanit Sp. z o.o.
ul. Wieleńska 2, 64-980 Trzcianka, POLAND
+48 67 253 23 60
alsanit@alsanit.pl
www.alsanit.pl

